

REVISIONS				
ZONE	REV.	DESCRIPTION	DATE	APPROVED
ALL	A	TABLE REDRAWN ECO 3290	12/10/86	
	B	REMOVED UNUSED P/N#	02/10/09	

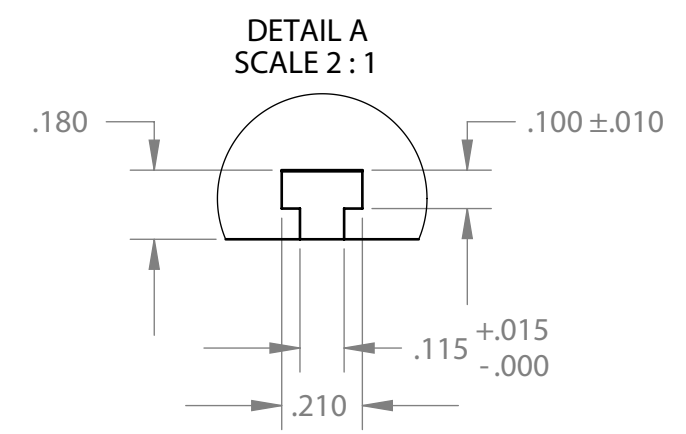

PART NO	"A" DIM.	DETAIL NO.
84HP	16.850	2
104HP	20.850	2
150HP	30.00 + 1.50/-0.00	1

EURORACK MODULAR SYNTH CASE RAILS AVAILABLE FROM
WWW.THONK.CO.UK

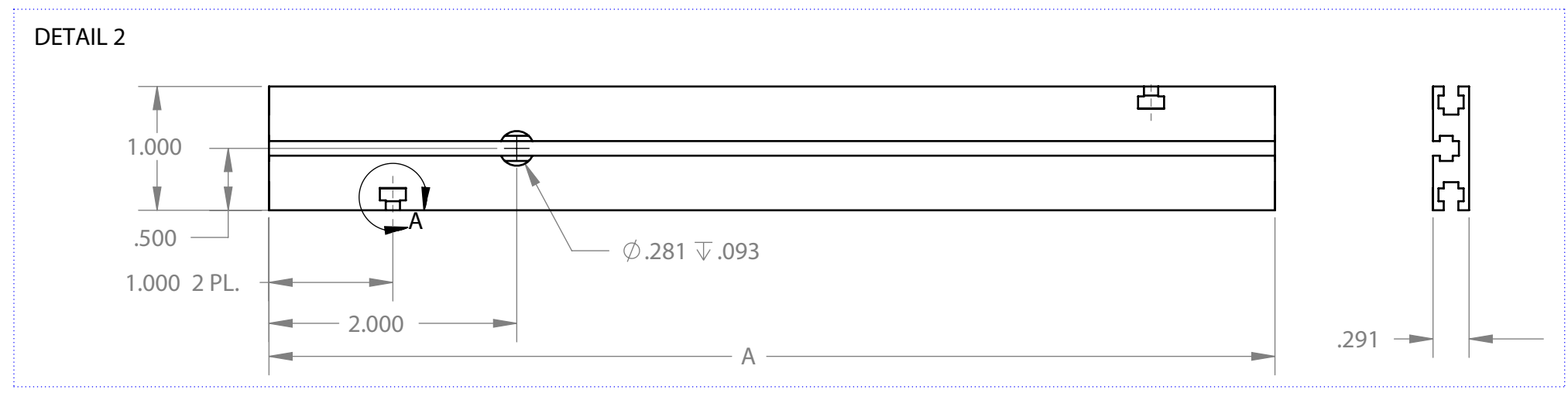
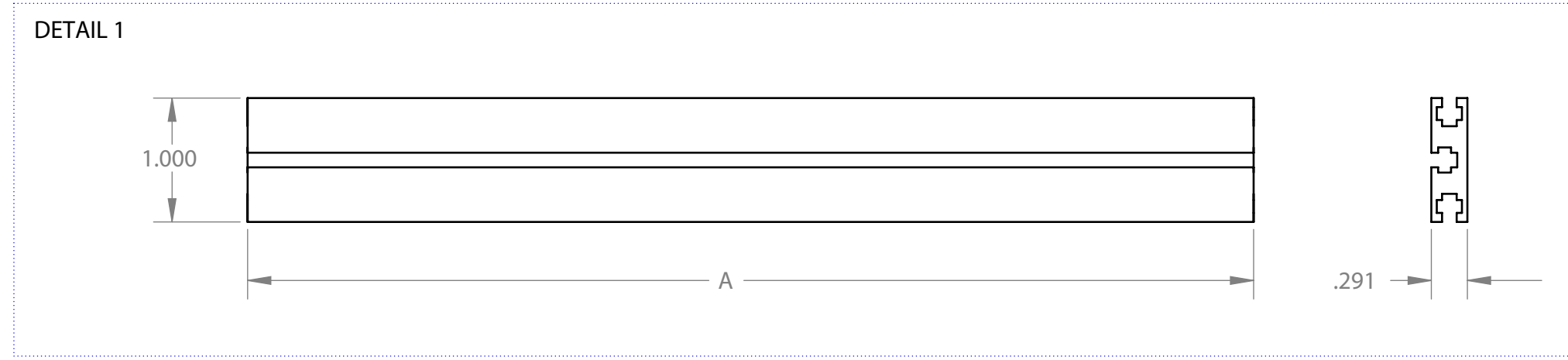

- 5. DEGREASE
 - 4. STRAIGHT WITHIN .015/10" IN LENGTH
 - 3. CUT ENDS TO BE SQUARE WITHIN .0025/INCH IN WIDTH
 - 2. REMOVE ALL BURRS
 - 1. MAT'L: AL. EXTRUSION, 6063-T6, PRE-ANOD., P/N TS100
- NOTES: UNLESS OTHERWISE SPECIFIED.

PROPRIETARY AND CONFIDENTIAL
 THE INFORMATION CONTAINED IN THIS
 DRAWING IS THE SOLE PROPERTY OF
 VECTOR ELECTRONICS & TECH., INC. ANY
 REPRODUCTION IN PART OR AS A WHOLE
 WITHOUT THE WRITTEN PERMISSION OF
 VECTOR ELECTRONICS & TECH., INC. IS
 PROHIBITED.

UNLESS OTHERWISE SPECIFIED:		NAME	DATE	VECTOR 11115 VANOWEN ST., NORTH HOLLYWOOD, ELECTRONICS & TECHNOLOGY, INC CA 91605						
DIMENSIONS ARE IN INCHES		DRAWN	TRUSHAR		02/06/09					
TOLERANCES:		CHECKED								
FRACTIONAL ±		ENG APPR.								
ANGULAR: ±X°		MFG APPR.								
TWO PLACE DECIMAL ±.03		Q.A.								
THREE PLACE DECIMAL ±.005		THIRD ANGLE PROJECTION								
INTERPRET GEOMETRIC TOLERANCING PER:		<table border="1"> <tr> <td>SIZE</td> <td>DWG. NO.</td> <td>REV</td> </tr> <tr> <td>B</td> <td>5280006</td> <td>B</td> </tr> </table>			SIZE	DWG. NO.	REV	B	5280006	B
SIZE	DWG. NO.	REV								
B	5280006	B								
MATERIAL	1									
FINISH										
DO NOT SCALE DRAWING		<table border="1"> <tr> <td>SCALE: 1:1</td> <td>WEIGHT:</td> <td>SHEET 1 OF 1</td> </tr> </table>			SCALE: 1:1	WEIGHT:	SHEET 1 OF 1			
SCALE: 1:1	WEIGHT:	SHEET 1 OF 1								